



AGM-21-C 2 DOOR REACH-IN GLASS DOOR REFRIGERATOR

INCLUDE 3 YEAR PARTS + LABOR / 5 YEAR COMPRESSOR WARRANTY

Dimensions

Exterior Dimensions (WxDxH)	42" x 29.8" x 60.9"
Interior Dimensions (WxDxH)	36.25" x 16.7" x 43.6"
20oz Bottle Capacity	Total 220
	Front 11
	Display 44
Unpackaged Weight	253.9 lbs
Packaging Dimensions (WxDxH)	42" x 29.8" x 60.9"

Construction

Exterior Material	Pre-painted steel
Interior Material	Pre-painted steel
Insulation Material	
Doors	2
Door Material	V7 Plastic Frame
Shelf Size (WxD)	35.4" x 14.7"
# Shelves	3
Shelf Load Capacity	

Cooling

Temperature Range	32° - 44.6° F
Refrigerant	R290
Maximum Ambient Temperature Rating	
Defrosting	Automatic
Temperature Display	Yes
Temperature Controller	Digital
H/P	1/3

Electrical

Voltage	115
Amps	4.8A
Hz	60
Controller	ETC1H

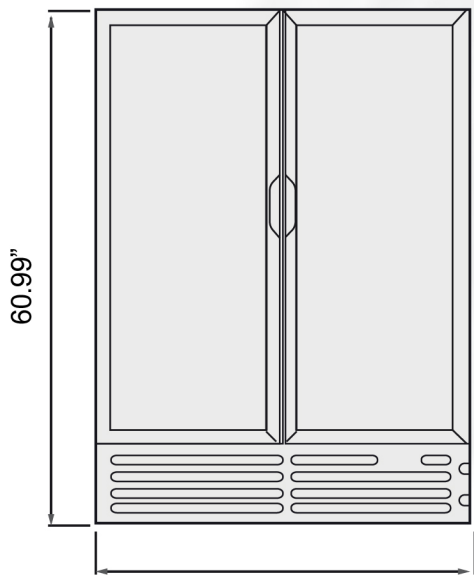

42"
Front View

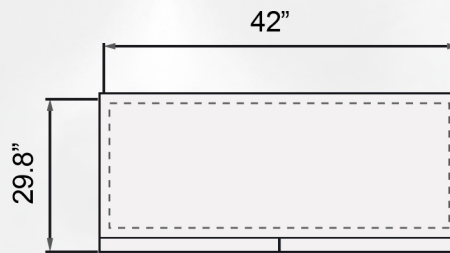

Top View

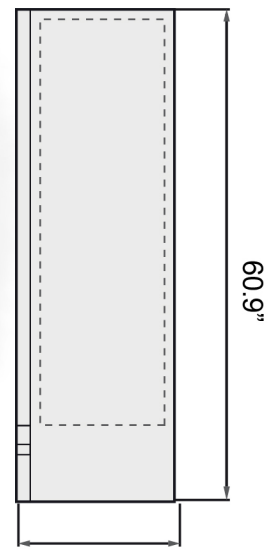

Side View



NEMA 5-15P



DOE

